

WOW ISTANBUL HOTEL & CONVENTION CENTER

FACT SHEET



wow

ISTANBUL

Hotels & Convention Center

WOW CONVENTION CENTER

Address : WOW Convention Center Yeşilköy Mahallesi
Atatürk Caddesi 34149
No: 15-17-19 Bakırköy / İstanbul

Tel : 00 90 212 468 50 00

Fax : 00 90 212 465 06 75

Website : www.wowhotelsistanbul.com

E-mail : info@wowconventionistanbul.com

Social media accounts :

[Facebook.com/wowistanbul](https://www.facebook.com/wowistanbul)
[Twitter.com/wow_istanbul](https://twitter.com/wow_istanbul)
[Instagram.com/wow_istanbul](https://www.instagram.com/wow_istanbul)
[Linkedin.com/wowistanbul](https://www.linkedin.com/wowistanbul)
[Youtube.com/wowistanbul](https://www.youtube.com/wowistanbul)

Category : A Block May 2007
B Block Construction Beginning July 2011
B Block Construction Ending March 2012

Date of Construction : May 2007

Total Area : 15.573 m²

Meeting Area : 8.500 m²

Valid Credit Cards : Amex, Diners, Visa, Master

Working Hours : Weekdays : 09:00 – 18:00
Saturday: 09:00 – 14:00



WOW CONVENTION CENTER

General Information

WOW Convention Center is a convention center integrated with 4-star WOW Airport Hotel and 5-star WOW Istanbul Hotel, capable of hosting national and international congresses, company meetings, product promotion, dealers meetings, fair and wedding organizations. It is the biggest convention center of Istanbul having accommodation facility with total 635 rooms, 34 meetings halls in 8.500 square meter activity area, and capacity of 6.500 persons. It consists of two blocks. Safir Hall, Istanbul's biggest meeting hall with its 3.108 m² area, as well as Artemis, Zeus and Oltu 1-2-3-4 halls are located in A Block. Multi-purpose Yakut Hall having telescopic tribune system which can be opened and closed is located in WOW Convention Center B Block. The capacity of other halls in the block varies between 27,5 m² and 1.180 m².

Location

WOW Convention Center is at a distance of 1 km from Atatürk International Airport, the most important airport of Istanbul, and at a walking distance to Istanbul Convention Center, CNR Expo Center where important fairs take place. Metro station linking to the city center is located in the garden of the facility.

Distances

Atatürk International Airport	: 1 km / 5 minutes
City Center (Taksim)	: 20 km / 30 minutes
Bakırköy Sea Buses	: 10 km / 18 minutes
Ataköy Marina	: 9 km / 16 minutes
Sabiha Gökçen International Airport	: 60 km / 55 minutes

There is free shuttle service to Atatürk International Airport and Taksim city center at certain times every day. Reservation is required for Taksim shuttle service.

WOW CONVENTION CENTER A BLOCK

USAGE AREA OF HALLS

	Safir	Zeus	Artemis	Oltu 1	Oltu 2	Oltu 3	Oltu 4
Area	3.108 m ²	225 m ²	180 m ²	20 m ²	52 m ²	52 m ²	20 m ²

Hall Features

Safir Hall

- 3.108 m² with no column
- Divisibility into 3 in 11 different styles
- Divisibility with separators those are soundproof up to 53 decibel
- 3 door entrances to Safir Hall
- 8,6 m ceiling height
- 1.260 m² foyer that can be divided into 3
- 3 different entrances to the foyer
- Two opposite symmetrical stage space of 146 m²
- Direct transition from parking garage to convention center foyer (moving staircase)
- Loading doors for material and equipment transfer to Safir Hall from outside

Artemis and Zeus Halls

- Divisibility into 5
- Divisibility with separators that are soundproof up to 53 decibel
- 4 m ceiling height
- 92 m² Artemis Hall foyer
- 93 m² Zeus Hall foyer

Oltu 1-2-3-4 Halls

- 4 meetings halls at the size of 20 m² - 50 m²
- Capacity varying between 5 to 50

Doors and Size

Safir Hall Material Entrance Doors

2 entrance doors that enable material and equipment loading to Safir Hall at the size of 5,60 m x 4,20 m

Safir Hall Foyer Entrance Photocell Doors

3 entrance doors to the main building at the size of 1,60 m x 2,35 m

Safir Hall Foyer Entrance Doors

3 entrance doors from Foyer to Safir Hall at the size of 1,78 m x 2,20 m

WOW Convention Center A Block Access

Access to all halls is provided with 3 photocell doors, and with staircases and moving staircases from the parking garage.

Access to Hotels

There is access from Safir Hall to the hotels.

HALL CAPACITY VALUES

WOW CONVENTION CENTER A BLOCK

Ground Floor

	Area	Hall (M ²)	Foyer (M ²)	Height (M)	Width (M)	Length (M)	Stage (Person)	Class (Person)	U Order (Person)	Banquet (Person)	Cocktail (Person)
Safir	A+B+C	3.108	1.260	8,6	42	74	4.000	1.980	-	2.000	3.000
	A	809	387	8,6	42	19,26	810	395	-	500	650
	A+	1.150	387	8,6	42	27,38	1.315	660	-	800	1.000
	A+B	1.958	858	8,6	42	46,61	2.380	1.090	-	1.400	1.600
	A+B+	2.298	858	8,6	42	54,71	2.920	1.385	-	1.420	2.000
	B	808	472	8,6	42	19,23	780	395	-	450	650
	B+	1.149	472	8,6	42	27,35	1.285	590	-	720	900
	+B+	1.491	472	8,6	42	35,5	1.705	790	-	930	1.100
	B+C	1.916	866	8,6	42	45,61	2.380	1.090	-	1.400	1.600
	C	809	394	8,6	42	19,26	810	395	-	500	650
	C+	1.150	394	8,6	42	27,38	1.315	660	-	800	900
	C+B+	2.299	866	8,6	42	54,73	2.920	1.385	-	1.420	2.000
Zeus	A+B+C	225	93	4	10	22,5	235	155	65	140	150
	A	72	-	4	10	7,2	70	30	25	30	-
	B	81	-	4	10	8,1	85	45	30	40	-
	C	72	-	4	10	7,2	70	30	25	30	-
	AB	153	-	4	10	15,3	160	105	40	90	-
	BC	153	-	4	10	15,3	160	105	40	90	-
Artemis	A+B+C	180	92	4	9,6	18,7	195	120	55	110	100
	A	56	-	4	9,6	5,82	60	30	-	20	-
	B	56	-	4	9,6	5,82	60	30	-	20	-
	C	68	-	4	9,6	7,06	70	30	25	30	-
	AB	112	-	4	9,6	11,64	115	70	30	60	-
	BC	124	-	4	9,6	12,88	115	85	30	60	-
Mezzanine											
Oltu	Oltu 1	20	-	2,4	3,6	5,5	15	-	10	-	-
	Oltu 2	52	-	2,4	5,6	9,4	50	30	25	-	-
	Oltu 3	52	-	2,4	5,6	9,4	50	30	25	-	-
	Oltu 4	20	-	2,4	3,6	5,5	15	-	10	-	-

A BLOCK SAFIR HALL

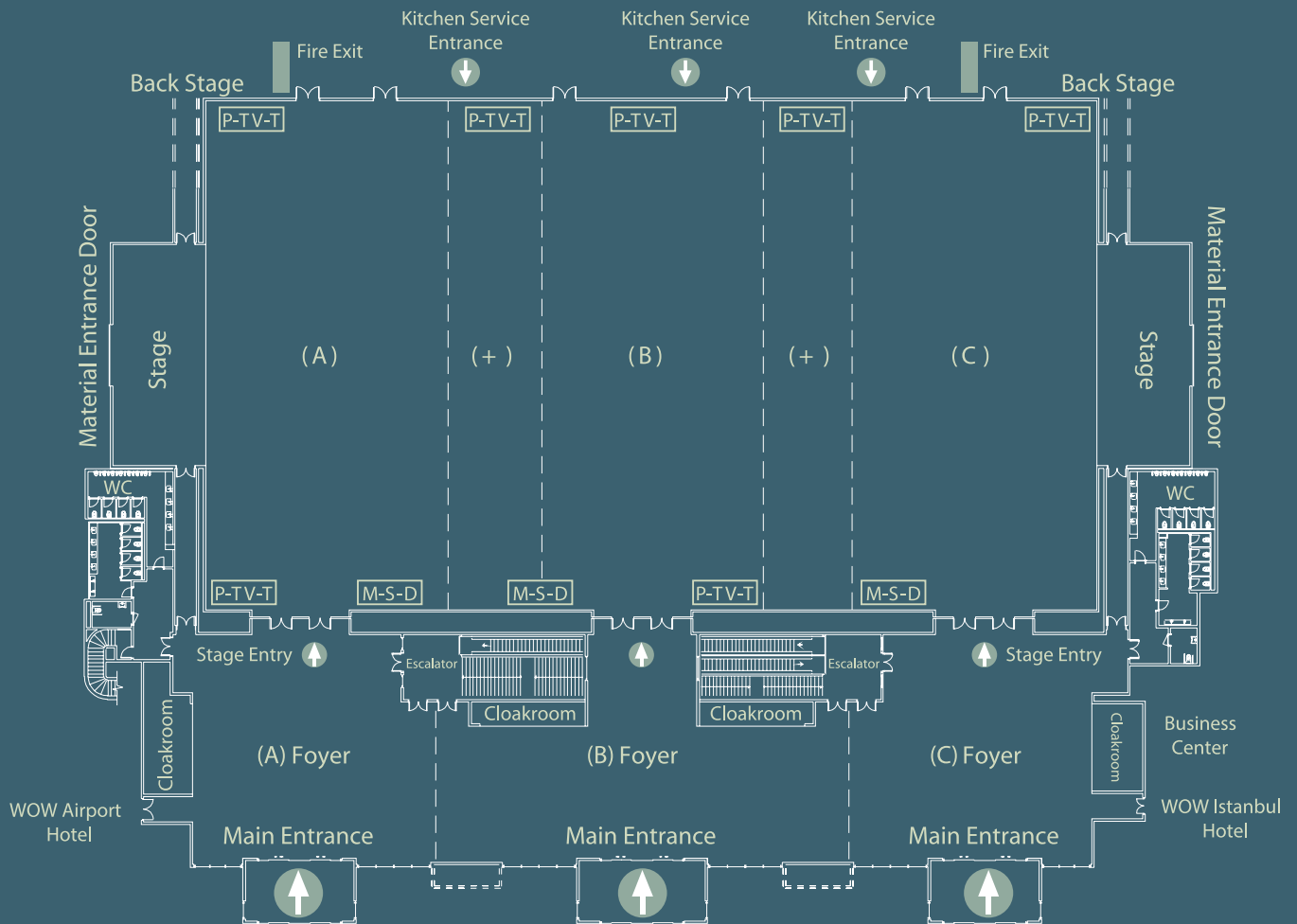

Width	: 42 m	P	: Electricity
Length	: 74 m	T	: Telephone - Data Line
Height min	: 7 m	M	: Music
Height max	: 8,6 m	S	: Sound Control
Area	: 3.108 m ²	D	: Dimmer Control
Foyer	: 1.260 m ²		

A BLOCK ARTEMIS HALL

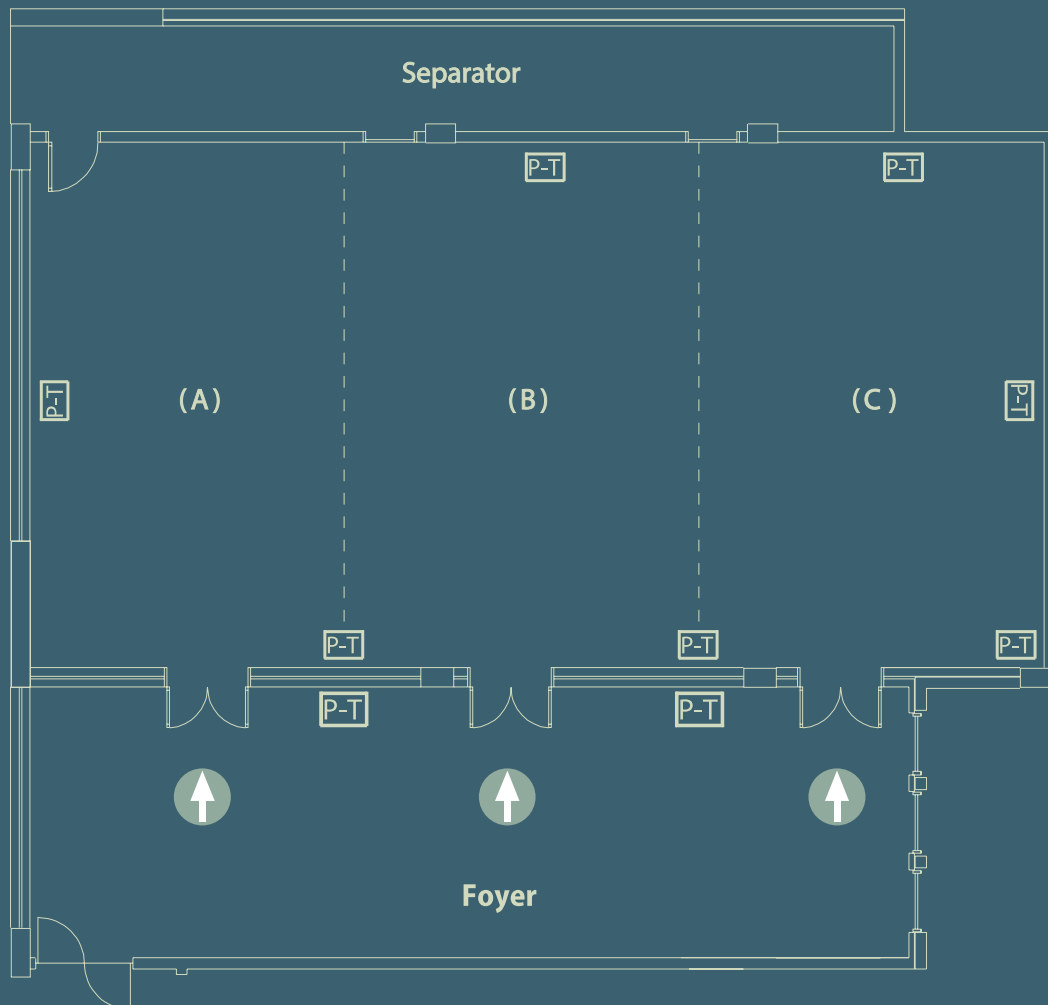

Width	: 9,6 m	P : Electricity
Length	: 18,7 m	T : Telephone - Data Line
Height min	: 4 m	
Height max	: 4 m	
Area	: 180 m ²	
Foyer	: 92 m ²	

A BLOCK

OLTU HALL 1 / 2 / 3 / 4

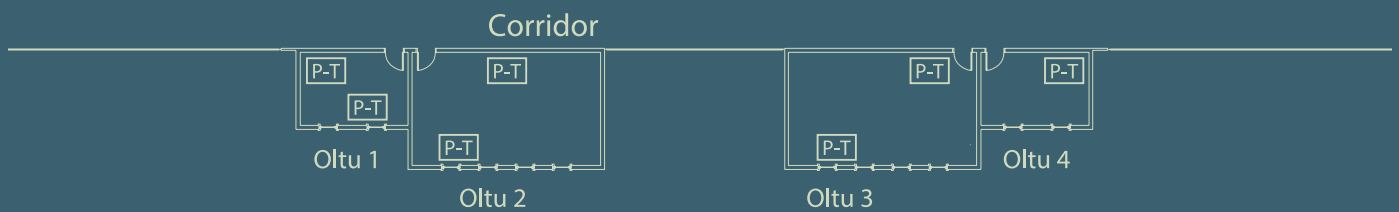

OLTU HALL 1

Width : 3,6 m
 Length : 5,5 m
 Height min : 2,4 m
 Height max : 2,4 m
 Area : 20 m²

OLTU HALL 2

Width : 5,6 m
 Length : 9,4 m
 Height min : 2,4 m
 Height max : 2,4 m
 Area : 52 m²

OLTU HALL 3

Width : 5,6 m
 Length : 9,4 m
 Height min : 2,4 m
 Height max : 2,4 m
 Area : 52 m²

OLTU HALL 4

Width : 3,6 m
 Length : 5,5 m
 Height min : 2,4 m
 Height max : 2,4 m
 Area : 20 m²

P: Electricity

T : Telephone - Data Line

WOW CONVENTION CENTER B BLOCK

USAGE AREA SIZE OF HALLS

Ground Floor	Yakut	Opal	Kehribar	Topaz	Akik	VIP	
	1.180 m ²	144 m ²	144 m ²	88 m ²	28 m ²	121 m ²	
1 St Floor	Mercan	Lapis	Kuvars	Akuamarin	Turkuaz	Ametist	Kalsedon
	228 m ²	105 m ²	71,5 m ²	71,5 m ²	71,5 m ²	70 m ²	47 m ²

Hall Features

Ground Floor

Yakut Hall

- Telescopic tribune system which can be opened and closed
- 1.180 m² with no column
- Divisibility with separators those are soundproof up to 51 decibel
- 6,7 m ceiling height
- 385 m² foyer area

Opal / Kehribar / Topaz / Akik Halls

- 4 meetings halls at the size of 28 m² - 144 m²
- Divisibility with separators that are soundproof up to 48 decibel
- 3,7 m ceiling height

VIP Hall

- 3 halls connected to each other for work, rest and office
- Total 121 m²

1st Floor

Mercan Hall

- Total 228 m²
- Divisibility with separators those are soundproof up to 48 decibel
- 3,7 m ceiling height

Kuvars / Akuamarin / Turkuaz / Ametist / Kalsedon / Lapis Halls

- 6 meetings halls at the size of 47 m² - 105 m²
- Capacity varying between 35 - 122 people

Doors and Size

Yakut Hall Material Entrance Doors

Doors that enable material and equipment loading to Yakut Hall at the size of 3,98 m

Yakut Hall Foyer Entrance Photocell Doors

3 entrance doors at the size of 3,95 m x 2,50 m

Yakut Hall Foyer Entrance Doors

3 entrance doors from foyer to hall at the size of 4,70 m x 2,20 m

WOW Convention Center B Block Access

Access to all halls is provided with 3 photocell doors, and with staircases from the parking garage.

HALL CAPACITY VALUES

WOW CONVENTION CENTER B BLOCK

Ground Floor

	Area	Hall (M ²)	Height (M)	Width (M)	Length (M)	Stage (Person)	Class (Person)	U Order (Person)	Banquet (Person)	Cocktail (Person)	Prolonge (Person)
Yakut	A+B+C	1.180	6,7	42,5	27,8	1.200	756	165	750	1.000	800
	A	391	6,7	14,1	27,8	320	198	100	240	350	250
	B	395	6,7	14,25	27,8	320	198	100	240	350	250
	C	391	6,7	14,1	27,8	320	198	100	240	350	250
	A+B	786	6,7	28,35	27,8	640	309	120	470	700	500
	BC	786	6,7	28,35	27,8	640	309	120	470	700	500
Foyer		385	3,8	7,75	49,45	-	-	-	-	330	250
Opal	A+B	144	3,6	11,4	12,8	132	72	36	90	-	-
	A	72	3,6	11,4	6,4	72	48	27	50	-	-
	B	72	3,6	11,4	6,4	72	48	27	50	-	-
Kehribar	A+B	144	3,6	11,4	12,8	132	72	36	90	-	-
	A	72	3,6	11,4	6,4	72	48	27	50	-	-
	B	72	3,6	11,4	6,4	72	48	27	50	-	-
Topaz	A+B	88	3,6	8	11	80	45	30	60	-	-
	A	43	3,6	8	5,4	40	24	21	-	-	-
	B	44	3,6	8	5,5	40	24	21	-	-	-
Akik		28	3,6	8	3,5	-	-	10	-	-	-
Foyer		168	3,8	7	24	-	-	-	-	180	150
VIP	VIP Meeting Room	58,5	-	-	-	-	-	20	-	-	-
	VIP Resting Room	40	-	-	-	-	-	-	-	-	-
	VIP Office	22,5	-	-	-	-	-	-	-	-	-

WOW CONVENTION CENTER B BLOCK

1 St Floor

	Area	Hall (M ²)	Height (M)	Width (M)	Length (M)	Stage (Person)	Class (Person)	U Order (Person)	Banquet (Person)	Cocktail (Person)	Prolonge (Person)
Mercan	A+B+C	228	3,7	11,4	20	252	108	69	120	180	150
	A	71,8	3,7	11,4	6,3	80	54	36	50	-	-
	A+B	164,3	3,7	11,4	14,4	180	105	51	90	-	-
	B	92,5	3,7	11,4	8,1	112	72	39	50	-	-
	B+C	154	3,7	11,4	13,5	162	90	48	80	-	-
	C	61,5	3,7	11,4	5,4	64	36	37	40	-	-
Lapis	A+B	105	3,7	8,9	11,8	112	72	45	-	-	-
	A	49	3,7	8,9	5,5	48	24	22	-	-	-
	B	56	3,7	8,9	6,3	54	24	25	-	-	-
Kuvars		71,5	3,7	11,4	6,3	56	30	28	-	-	-
Akuamarin		71,5	3,7	11,4	6,3	56	30	28	-	-	-
Turkuaz		71,5	3,7	11,4	6,3	56	30	28	-	-	-
Ametist		70	3,7	11,1	6,3	56	30	28	-	-	-
Kalsedon		47	3,7	8,9	5,3	35	24	20	-	-	-
Foyer		196	3,8	12,9	15,2	-	-	-	-	180	150

WOW CONVENTION CENTER B BLOCK GROUND FLOOR SETTLEMENT PLAN

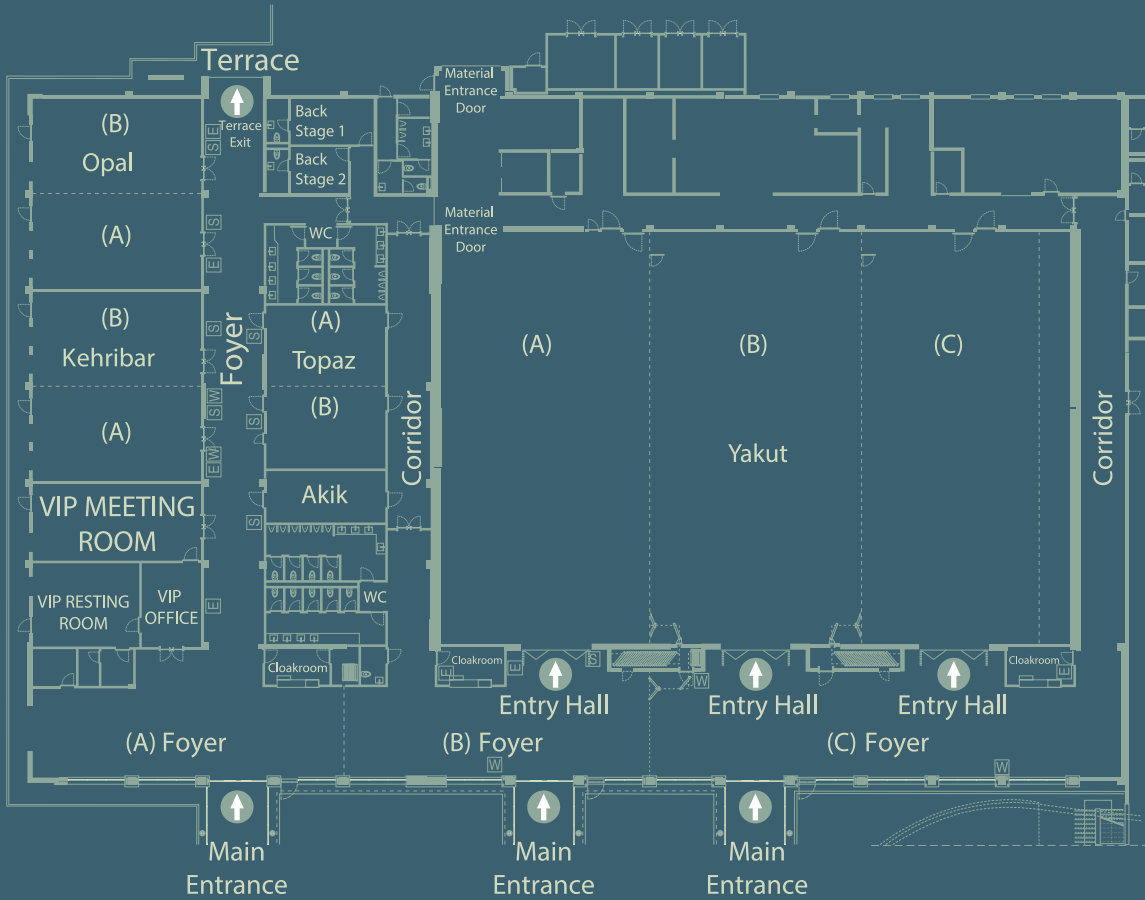

- E : Power Outlet (Network)
- T : Telephone Line
- U : UPS
- TV : Television Socket
- W : Wireless
- S : Sound - Video
- P : Projection
- D : Data Line

B BLOCK YAKUT HALL

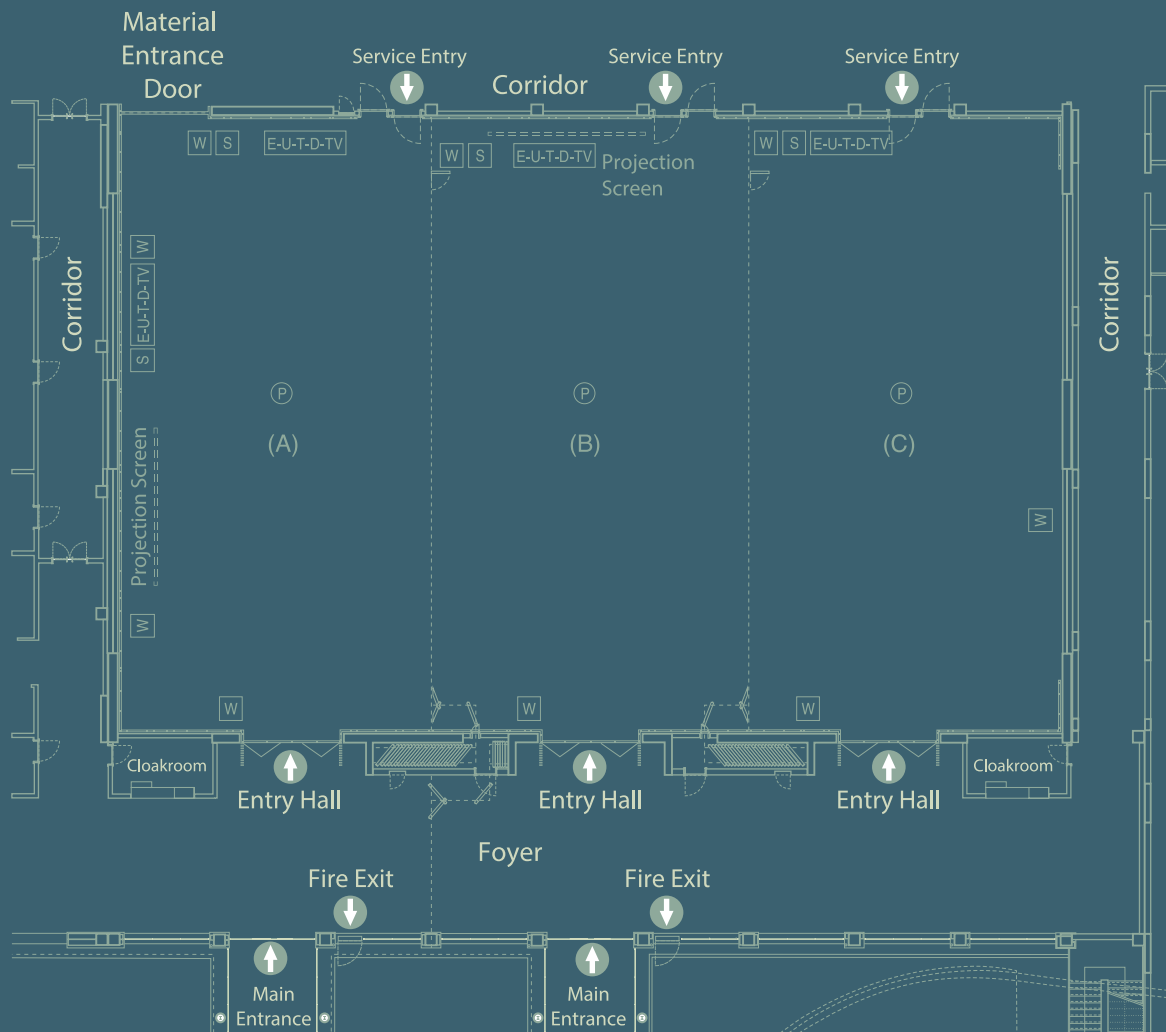

YAKUT HALL A+B+C

Width : 42,50 m
 Length : 27,80 m
 Height min : 6,60 m
 Height max : 6,70 m
 Area : 1.180 m²
 Foyer : 385 m²

YAKUT HALL A

Width : 14,1 m
 Length : 27,80 m
 Height min : 6,60 m
 Height max : 6,70 m
 Area : 391 m²

YAKUT HALL B

Width : 14,25 m
 Length : 27,80 m
 Height min : 6,60 m
 Height max : 6,70 m
 Area : 395 m²

YAKUT HALL C

Width : 14,1 m
 Length : 27,80 m
 Height min : 6,60 m
 Height max : 6,70 m
 Area : 391 m²

E : Power Outlet (Network)
 T : Telephone Line
 U : UPS
 TV : Television Socket
 W : Wireless
 S : Sound - Video
 P : Projection
 D : Data Line

B BLOCK KEHRİBAR HALL

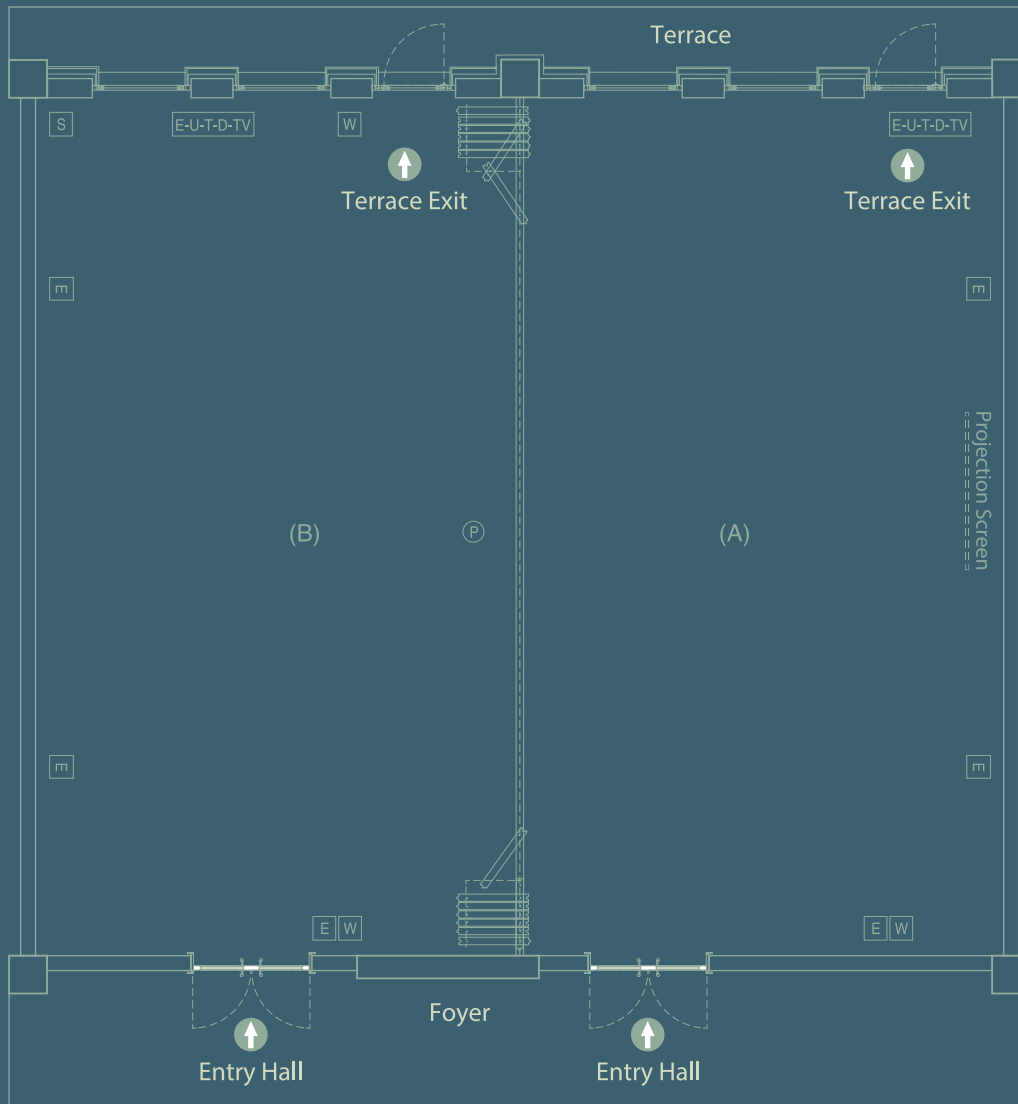

KEHRİBAR HALL A+B

Width : 11,4 m
Length : 12,8 m
Height min : 3,45 m
Height max : 3,6 m
Area : 144 m²

KEHRİBAR HALL A

Width : 11,4 m
Length : 6,4 m
Height min : 6,6 m
Height max : 6,7 m
Area : 72 m²

KEHRİBAR HALL B

Width : 11,4 m
Length : 6,4 m
Height min : 6,6 m
Height max : 6,7 m
Area : 72 m²

E : Power Outlet (Network)

T : Telephone Line

U : UPS

TV : Television Socket

W : Wireless

S : Sound - Video

P : Projection

D : Data Line

B BLOCK OPAL HALL

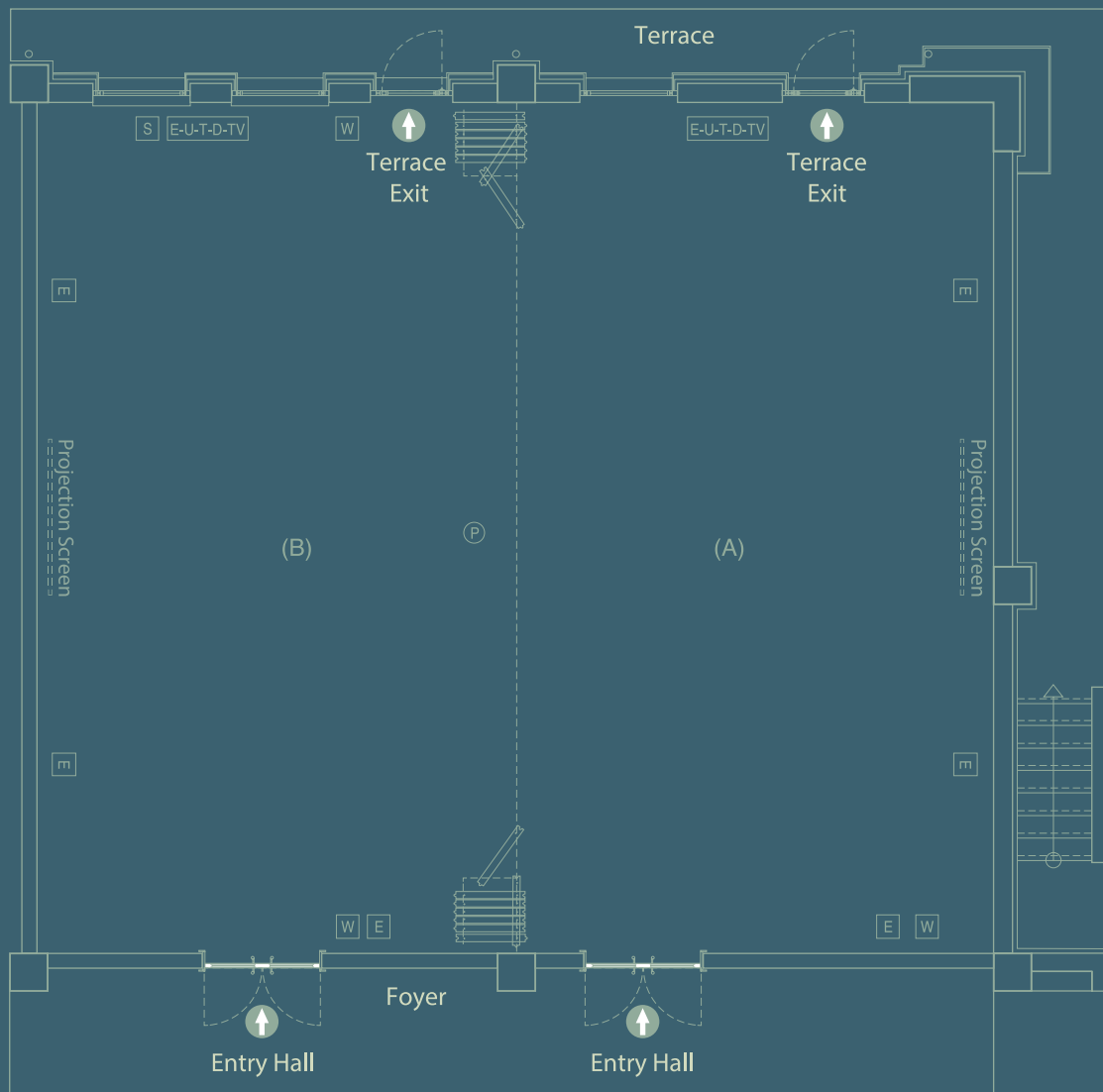

OPAL HALL A+B

Width : 11,40 m
 Length : 12,80 m
 Height min : 3,45 m
 Height max : 3,60 m
 Area : 144 m²

OPAL HALL A

Width : 11,4 m
 Length : 6,4 m
 Height min : 6,60 m
 Height max : 6,70 m
 Area : 72 m²

OPAL HALL B

Width : 11,4 m
 Length : 6,4 m
 Height min : 6,60 m
 Height max : 6,70 m
 Area : 72 m²

E : Power Outlet (Network)

T : Telephone Line

U : UPS

TV : Television Socket

W : Wireless

S : Sound - Video

P : Projection

D : Data Line

B BLOCK TOPAZ HALL

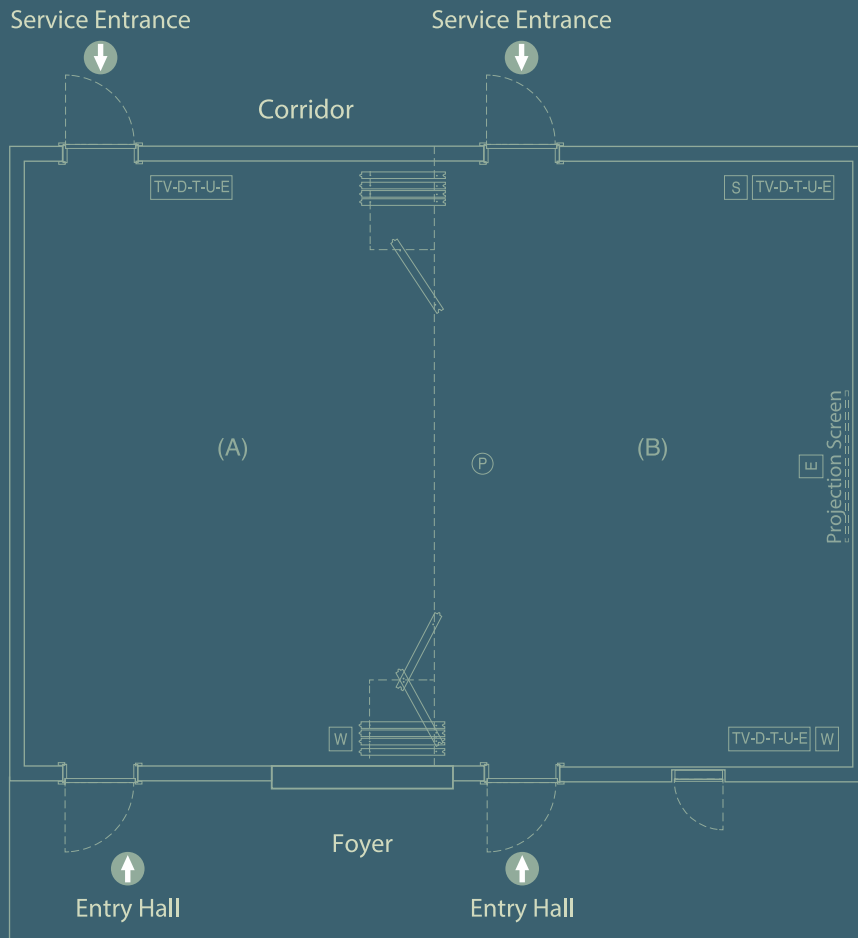

TOPAZ HALL A+B

Width : 8 m
 Length : 11 m
 Height min : 3,45 m
 Height max : 3,6 m
 Area : 88 m²

TOPAZ HALL A

Width : 8 m
 Length : 5,4 m
 Height min : 3,45 m
 Height max : 3,6 m
 Area : 43 m²

TOPAZ HALL B

Width : 8 m
 Length : 5,5 m
 Height min : 3,45 m
 Height max : 3,6 m
 Area : 44 m²

E : Power Outlet (Network)

T : Telephone Line

U : UPS

TV : Television Socket

W : Wireless

S : Sound - Video

P : Projection

D : Data Line

B BLOCK AKIK HALL

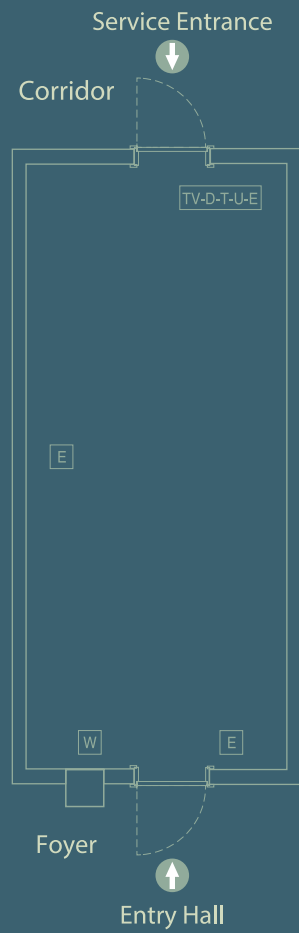

Width : 8 m
Length : 3,50 m
Height min : 3,45 m
Height max : 3,60 m
Area : 28 m²

E : Power Outlet (Network)
T : Telephone Line
U : UPS
TV : Television Socket
W : Wireless
S : Sound - Video
P : Projection
D : Data Line

B BLOK VIP ROOMS

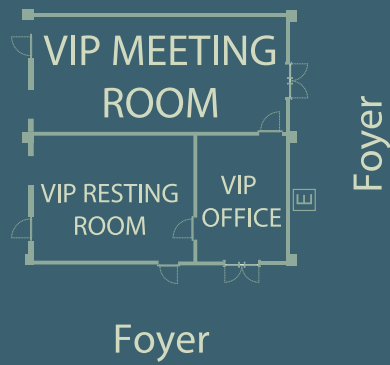

VIP Meeting Room: 58,5 m²
VIP Resting Room : 40 m²
VIP Office : 22,5 m²

E : Power Outlet (Network)
T : Telephone Line
U : UPS
TV : Television Socket
W : Wireless
S : Sound - Video
P : Projection
D : Data Line

WOW CONVENTION CENTER B BLOCK

1 ST FLOOR SETTLEMENT PLAN

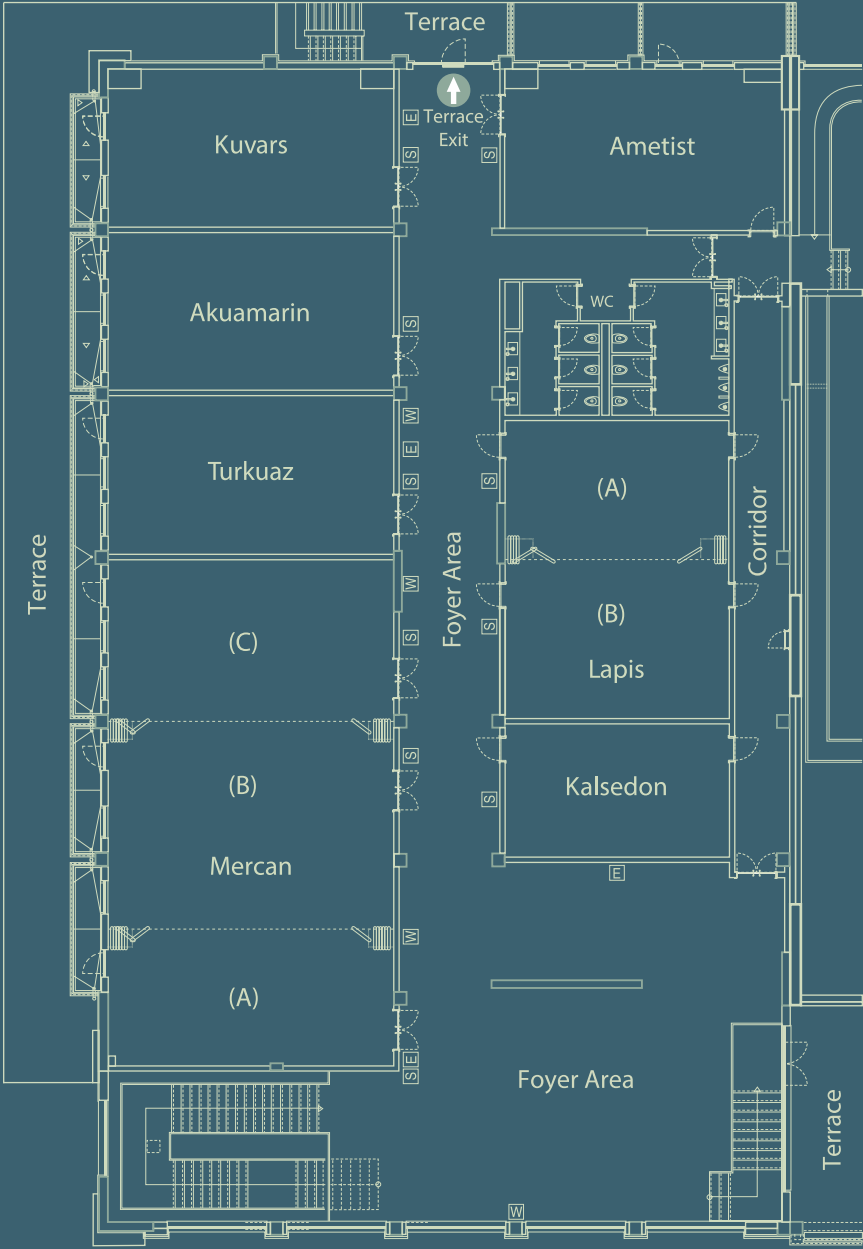

- E : Power Outlet (Network)
- T : Telephone Line
- U : UPS
- TV : Television Socket
- W : Wireless
- S : Sound - Video
- P : Projection
- D : Data Line

B BLOCK 1 ST FLOOR MERCAN HALL

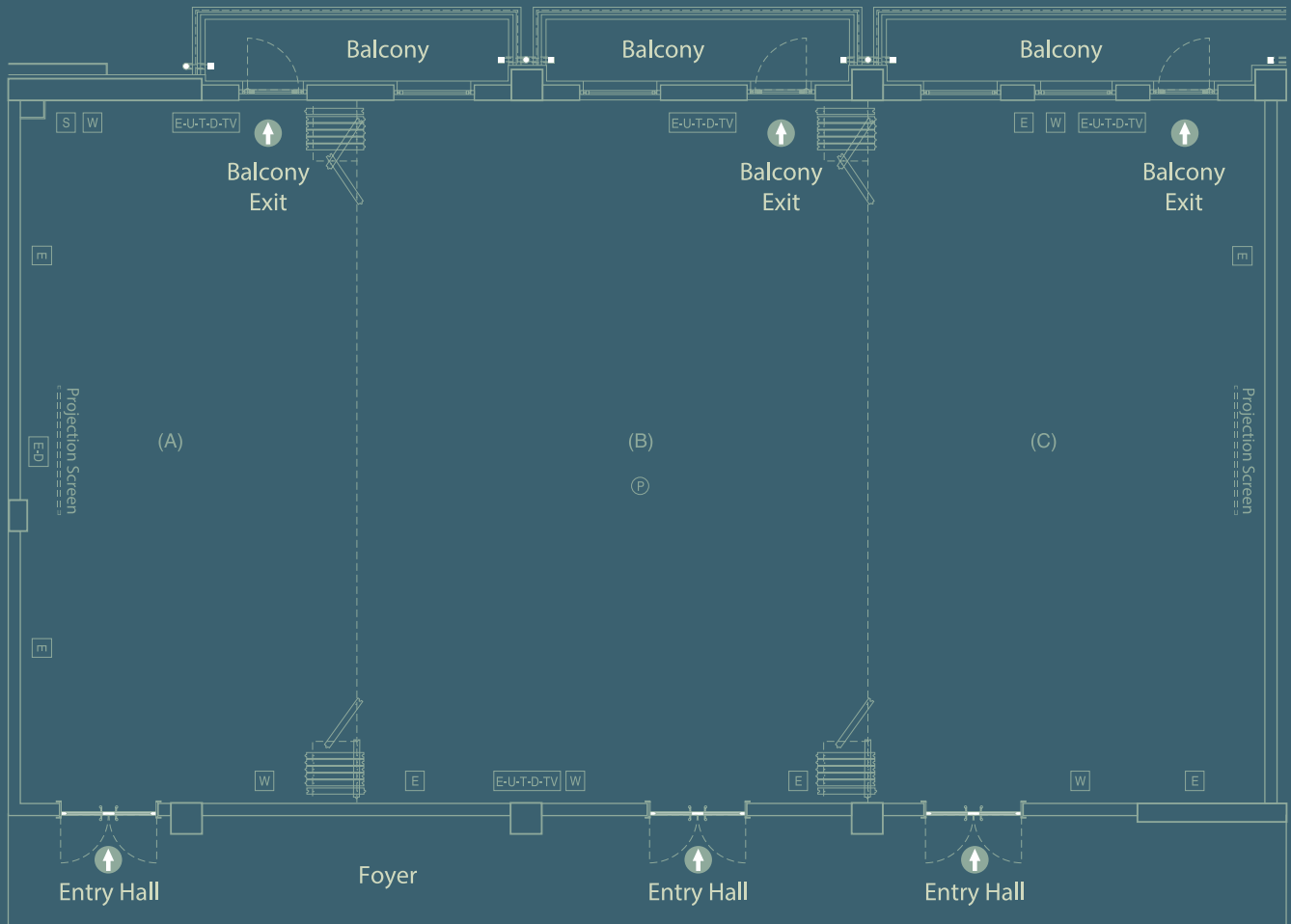

MERCAN HALL A+B+C

Width : 11,40 m
Length : 20 m
Height min : 3,45 m
Height max : 3,70 m
Area : 228 m²

MERCAN HALL A

Width : 11,4 m
Length : 6,3 m
Height min : 6,60 m
Height max : 6,70 m
Area : 71,8 m²

MERCAN HALL B

Width : 11,4 m
Length : 8,1 m
Height min : 6,60 m
Height max : 6,70 m
Area : 92,5 m²

MERCAN HALL C

Width : 11,4 m
Length : 5,4 m
Height min : 6,60 m
Height max : 6,70 m
Area : 61,5 m²

E : Power Outlet (Network)
T : Telephone Line
U : UPS
TV : Television Socket
W : Wireless
S : Sound - Video
P : Projection
D : Data Line

B BLOCK 1 ST FLOOR LAPIS HALL

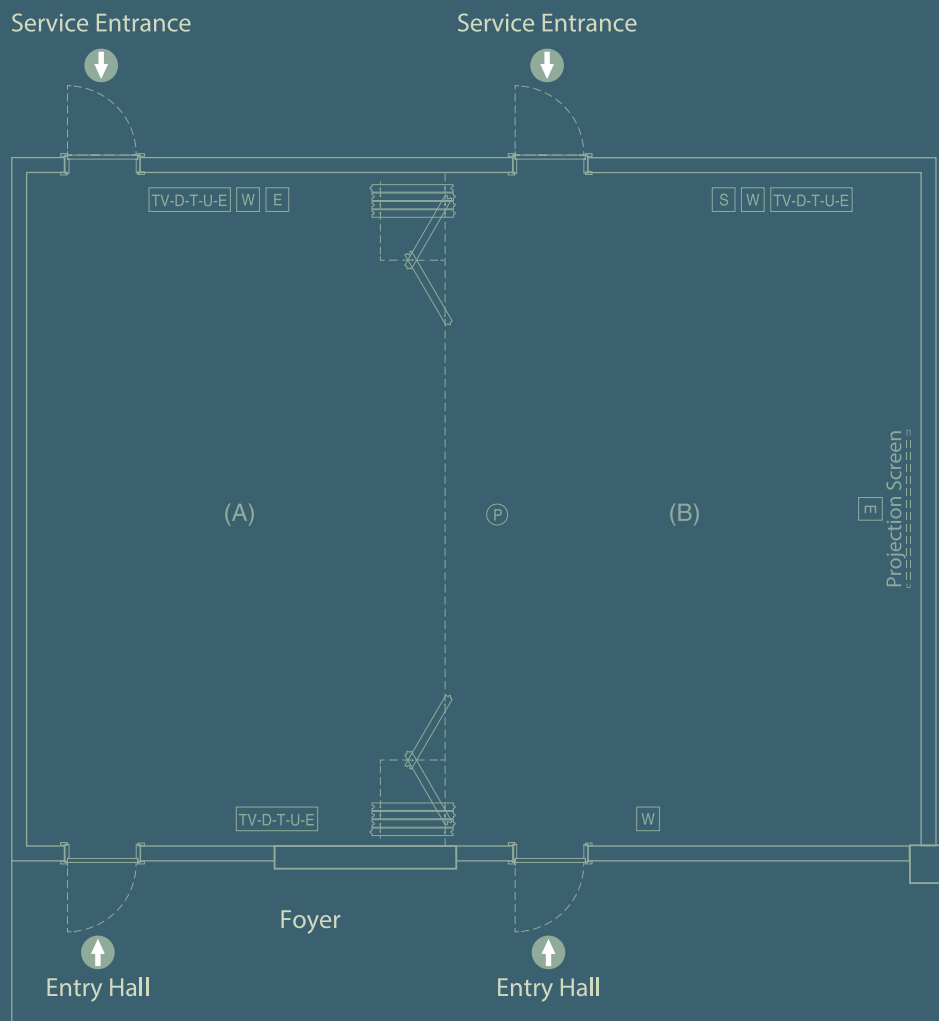

LAPIS HALL A+B

Width : 8,90 m
Length : 11,80 m
Height min : 3,45 m
Height max : 3,70 m
Area : 105 m²

LAPIS HALL A

Width : 8,90 m
Length : 5,5 m
Height min : 3,45 m
Height max : 3,70 m
Area : 49 m²

LAPIS HALL B

Width : 8,90 m
Length : 6,3 m
Height min : 3,45 m
Height max : 3,70 m
Area : 56 m²

E : Power Outlet (Network)

T : Telephone Line

U : UPS

TV : Television Socket

W : Wireless

S : Sound - Video

P : Projection

D : Data Line

B BLOCK 1 ST FLOOR AMETIST HALL

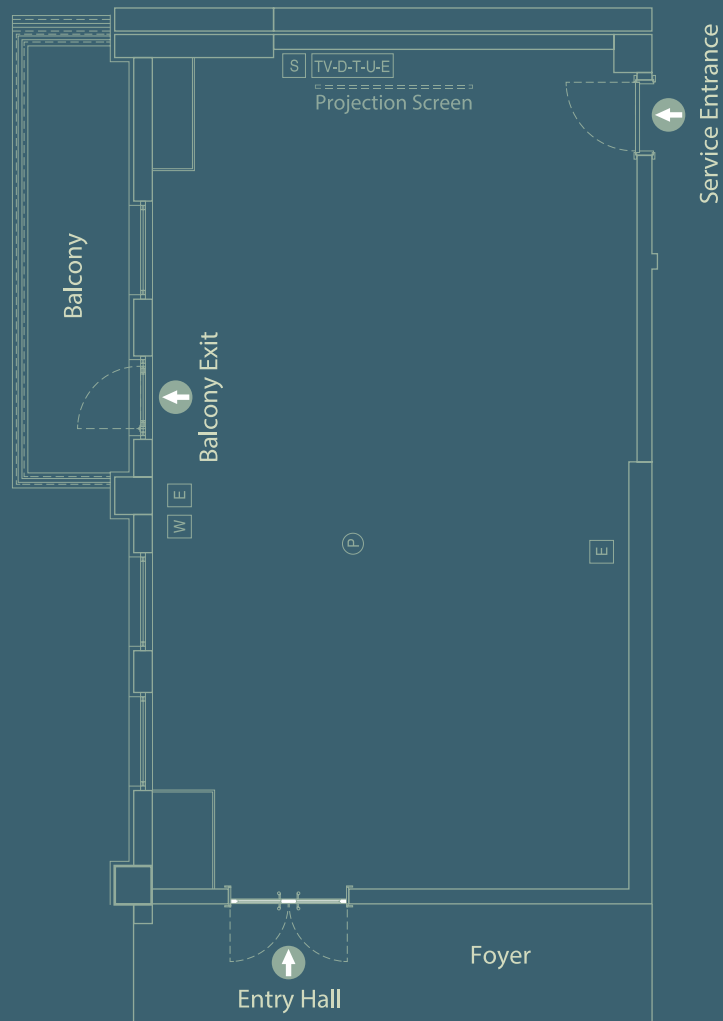

Width : 11,10 m
 Length : 6,30 m
 Height min : 3,45 m
 Height max : 3,70 m
 Area : 70 m²

E : Power Outlet (Network)
 T : Telephone Line
 U : UPS
 TV : Television Socket
 W : Wireless
 S : Sound - Video
 P : Projection
 D : Data Line

B BLOCK 1 ST FLOOR KALSEDON HALL

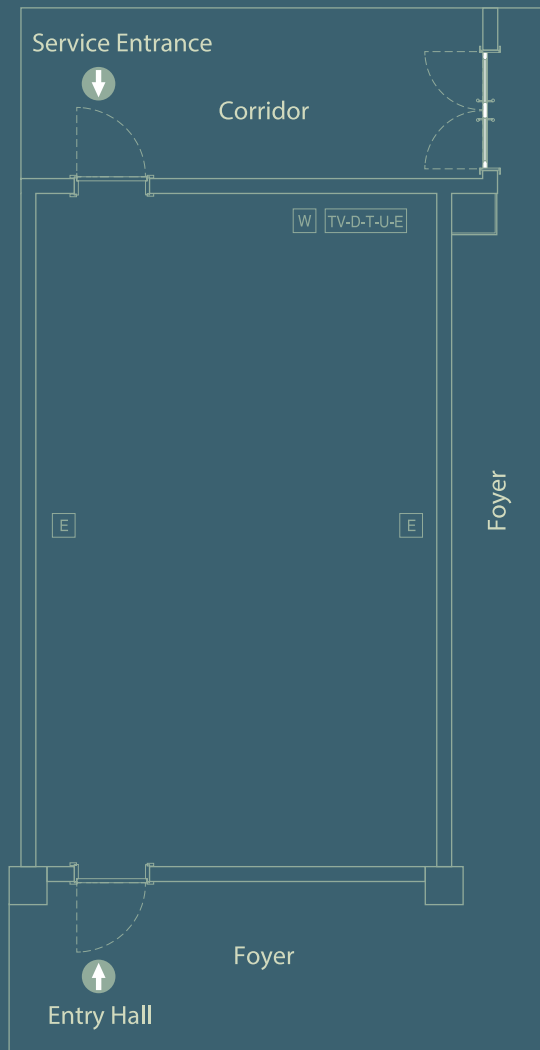

Width : 8,90 m
Length : 5,30 m
Height min : 3,45 m
Height max : 3,70 m
Area : 47 m²

E : Power Outlet (Network)
T : Telephone Line
U : UPS
TV : Television Socket
W : Wireless
S : Sound - Video
P : Projection
D : Data Line

B BLOCK 1 ST FLOOR KUVARS HALL

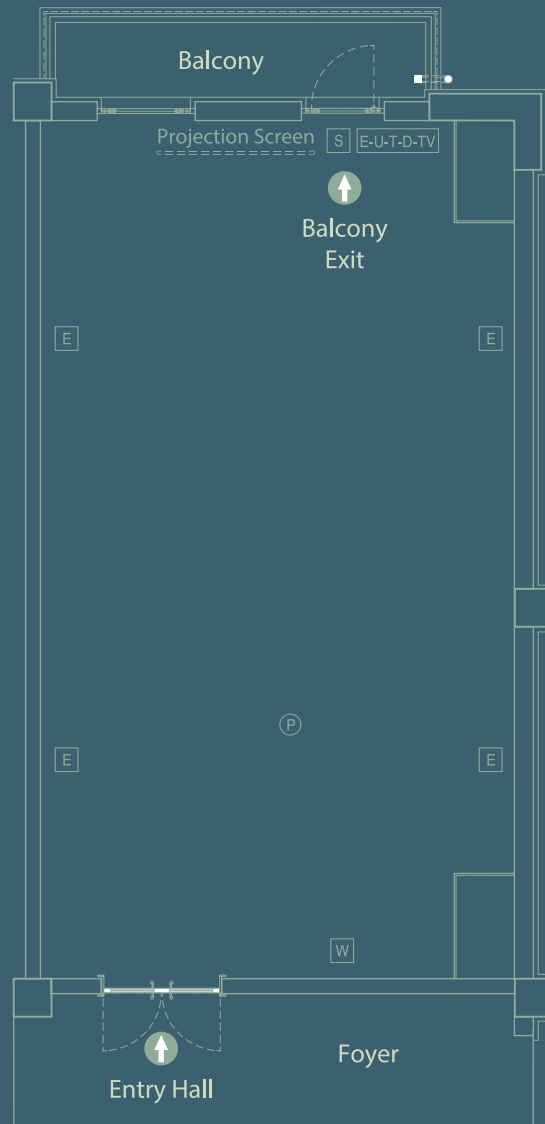

Width : 11,40 m
Length : 6,30 m
Height min : 3,45 m
Height max : 3,70 m
Area : 71,5 m²

E : Power Outlet (Network)
T : Telephone Line
U : UPS
TV : Television Socket
W : Wireless
S : Sound - Video
P : Projection
D : Data Line

B BLOCK 1 ST FLOOR AKUAMARIN HALL

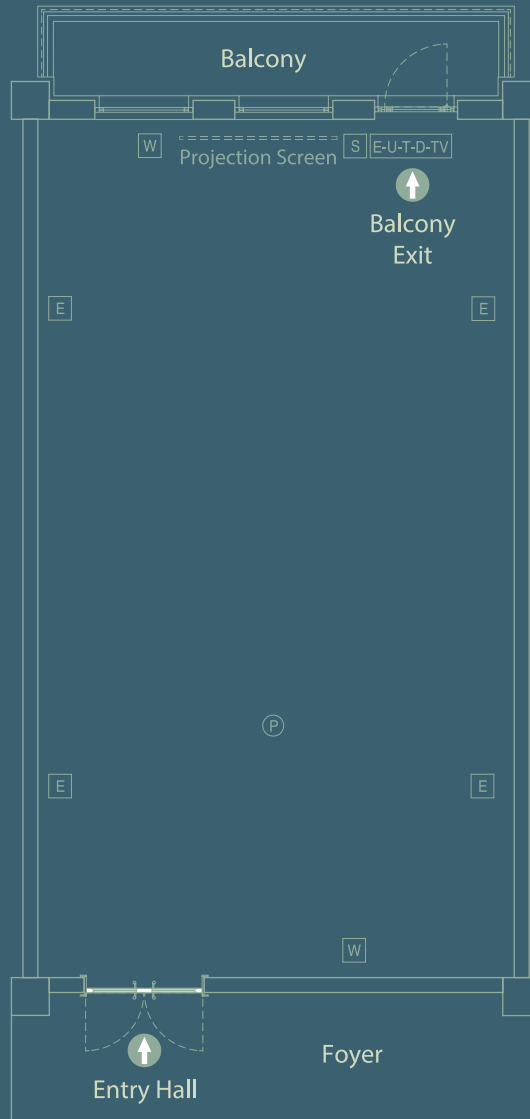

Width : 11,40 m
 Length : 6,30 m
 Height min : 3,45 m
 Height max : 3,70 m
 Area : 71,5 m²

E : Power Outlet (Network)
 T : Telephone Line
 U : UPS
 TV : Television Socket
 W : Wireless
 S : Sound - Video
 P : Projection
 D : Data Line

B BLOCK 1 ST FLOOR TURKUAZ HALL

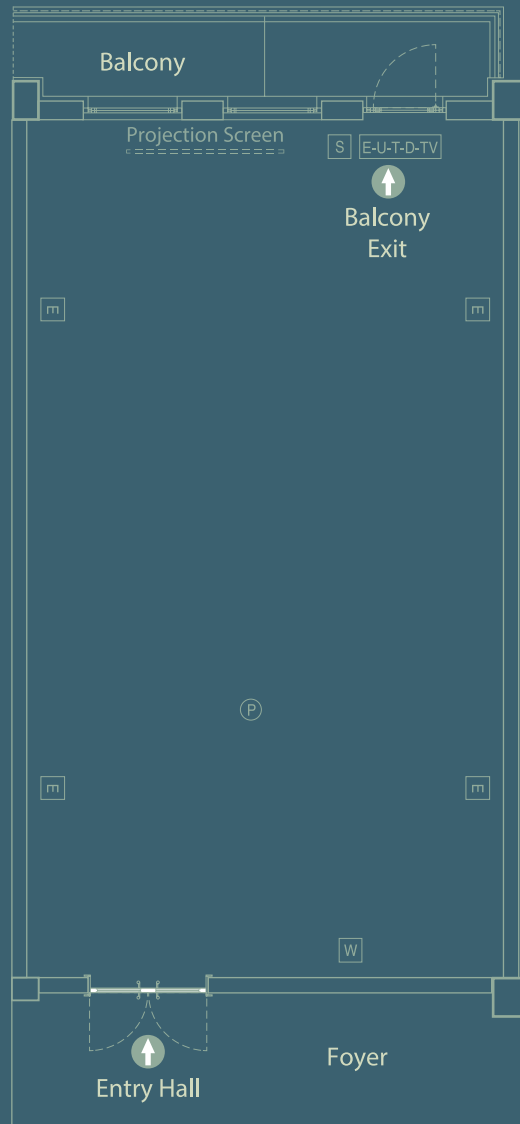

Width : 11,40 m
Length : 6,30 m
Height min : 3,45 m
Height max : 3,70 m
Area : 71,5 m²

E : Power Outlet (Network)
T : Telephone Line
U : UPS
TV : Television Socket
W : Wireless
S : Sound - Video
P : Projection
D : Data Line